

订正 REVISION	年月日 DATE	原编号 OLD CODE	记事 DESCRIPTION	订正编号 CHANGE ORDER NO.	设计 DESIGN	批准 APPRO

未注公差 General tolerance	JIS B0405-m JIS B0419-K
未注粗糙度 General roughness	
铸件公差 Casting tolerance	

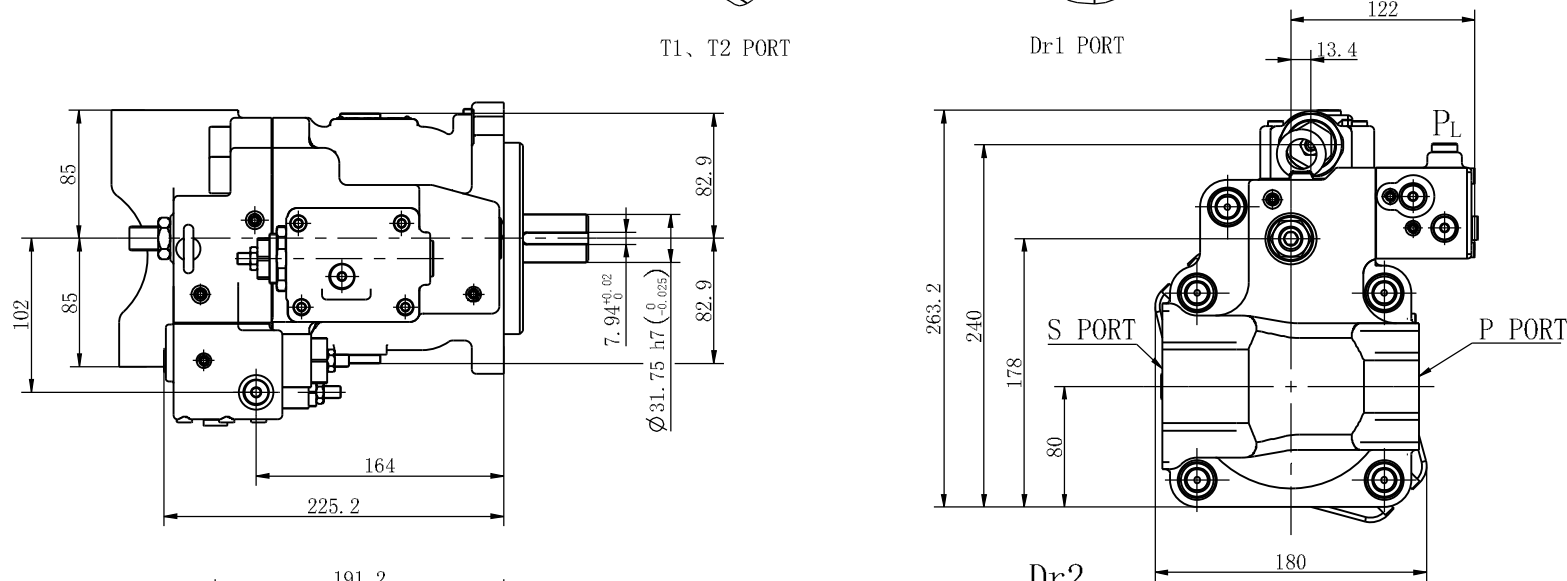
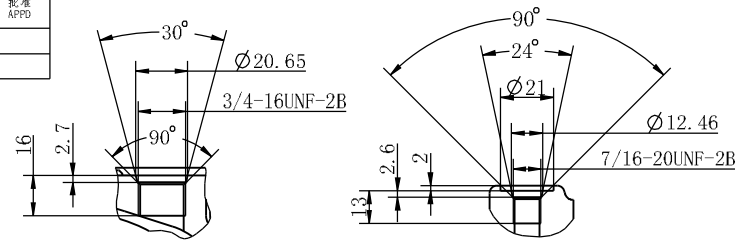

1. PRECAUTIONS FOR ASSEMBLING.
- (1) BEFORE ASSEMBLING, THE CLEANLINESS OF TANK AND TUBING MUST REACH ISO4406 18/15.
 - (2) BEFORE ASSEMBLING, CONFIRM THAT NO BURRS LEFT ON JOINING SURFACES AND TAKE CARE THAT NO DUST ENTERS.
 - (3) DURING ASSEMBLING, SLING SHOULD BE USED.
 - (4) WHEN LIFTING, AVOID CONTACT WITH PORT.
 - (5) TAKE CARE THAT NO DUST ENTER PORT.
 - (6) BE CAREFUL THAT DO NOT HURT THE SPLINE, AND LOOSEN SPLINE AFTER BINDING BOLTS FASTENED.
2. PRECAUTIONS FOR OPERATION.
- (1) BEFORE OPERATION, FILL UP HYDRAULIC OIL IN PUMP CASE THROUGH PUMP DRAIN PORT (T1) OR Dr2.
 - (2) BEFORE OPERATION, PURGE AIR.
 - (3) WHEN RUNNING PUMP, KEEP OIL AND OTHER FLUID FROM THE SURFACE OF PUMP ASS'Y.
 - (4) BE CAREFUL NOT TO GIVE SHOCKS TO THE DRIVE SHAFT, ETC WHEN TRANSPORTING THE PUMP.

PUMP PARAMETER				
PUMP MODE		HP3V80/AV10RKS-P0/1		
CUSTOMER				
DIRECTION OF ROTATION		CLOCKWISE		
STRUCTURE OF PUMP		AXIAL VARIABLE PUMP		
THEORETICAL DISPLACEMENT	VARIABLE PUMP	MAX cc/r	80	
		MIN cc/r	4	
DELIVERY PRESSURE	VARIABLE PUMP	RATED MPa	32	
		PEAK MPa	35	
REVOLUTION SPEED	MIN rpm	600		
	RATED rpm	2400		
	MAX rpm	3000		
MIN PRESSURE AT SUCTION PORT		MPa	0.08	
CASE DRAIN PRESSURE	NORMAL	MPa	0.1	
	PEAK	MPa	0.3	
CONTROL METHOD	PC	27HP*1750 RPM (ADJUSTABLE) POWER CONTROL		
	LS	no LOAD SENSING function		
	DR	P=32MPa, remote pressure control		
AMBIENT TEMP.		-30°C~80°C		
WORKING CONDITION	HYDRAULIC FLUID	CLASS OF OIL	H046-HM (GB3141-1994)	
		WORKING TEMP. RANGE	-30°C~100°C	
		NORMAL TEMP.	10°C~80°C	
		WATER CONTENT	MAX 0.1%	
		CONTAMINATION LEVEL	MAX ISO4406 18/15	
	FILTER	SUCTION	MOUNTING POSITION	IN TANK
			FILTRATION	150MESH
		LINE	FLUID VELOCITY	MAX 0.2m/s
			MOUNTING POSITION	RETURN CIRCUIT IN TANK
			FILTRATION SIZE	20µ
WEIGHT (APPR.) (DRY)		38.5		

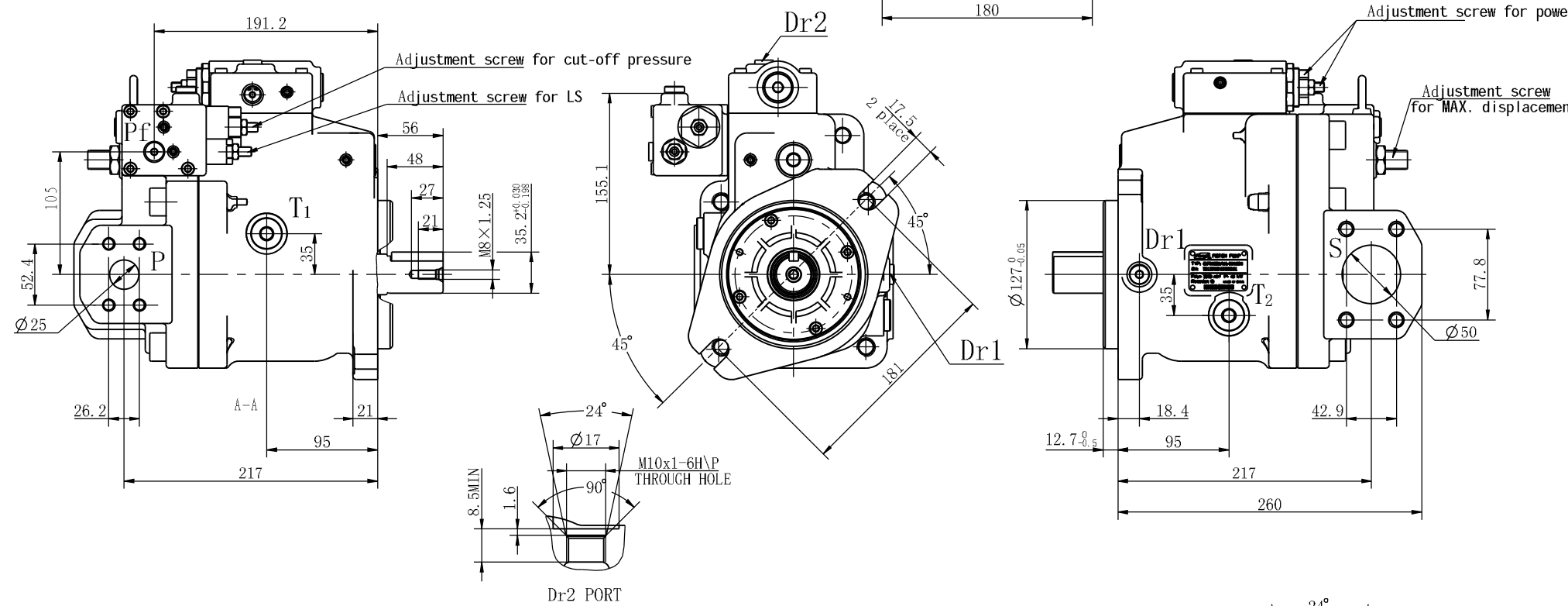

PORT NAME	PORT SIZE AND DESCRIPTION	TORQUE (N·m)
P DELIVERY PORT	1" SAE J518C Code 61 (5000psi)	57
	3/8"-16UNC -2B (depth 0.71")	
S SUCTION PORT	2" SAE J518C Code 61 (3000psi)	98
	1/2"-13UNC-2B(depth 0.87")	
T1, T2 DRAIN PORT	1/2" O-Ring Boss- SAE J1926/1(3/4"-16UNF-2B)	75
PL LS PORT	1/4" O-Ring Boss- SAE J1926/1(7/16"-20UNF-2B)	12
Dr1 AIR BLEED PORT	1/4" O-Ring Boss- SAE J1926/1(7/16"-20UNF-2B)	12
Dr2 AIR BLEED PORT	M10×1 (10.5mm depth) ISO6149-1	12

Drawn By	Common Name	HP3V80/AV10RKS-P0/1	Code			
Proofed By	Name	INSTALLATION	Version	A0		
Craft	Material		Weight	Scale	Mapsheet	
Standardization			38.5	3:10	A1	
Checked By			PAGE 1/1	View		
Approved By	JIANGSU HENGLI HYDRAULIC CO., LTD					

借通用件登记
CURRENT REGISTER

描图
TRACING

校描
REVISER

旧底图总号
OLD NO.

签字
SIGNATURE

日期
DATE